



Central Valley Gas Storage LLC  
3333 Warrenville Road  
Suite 300  
Lisle, IL 60532

Phone 630 245-6150  
Fax 630 245-7835  
Internet www.CVGasStorage.com

May 27, 2011

Mr. Eric Chiang  
California Public Utilities Commission  
505 Van Ness Ave, 4<sup>th</sup> Floor  
San Francisco, CA 94610

Subject: Central Valley Natural Gas Storage Project – Request for Issuance of a Notice to Proceed (NTP #6d) for Pacific Gas & Electric Electrical Pole Installation to Support Power to the Remote Well Pad and Project Offices

Dear Eric:

Central Valley Gas Storage, LLC (CVGS) is requesting the CPUC's issuance of a notice to proceed (NTP #6d) for the relocation of an existing electrical pole on McAusland Road and installation of a new electric pole on Southam Road. The poles are being installed to support connection to PG&E's existing 12kV electrical distribution line and to provide power to the remote well pad and project temporary offices (the relocated and new poles are indicated by a black "X" in the attached figures). A description of each of these pole installations is described below.

#### Power to the Remote Well Pad

PG&E will route power to the remote well pad area from State Route 45 using mainly their existing poles along the north side of Southam Road and the east side of McAusland Road. To support this connection, PG&E will install one new pole between two of their existing poles on the east side of McAusland Road. This new pole and associated guy wire has been highlighted in the attached sketch. PG&E will be mounting a transformer on this new pole. From the transformer, PG&E will route power across McAusland Road to another new pole that has been installed by CVGS on the remote well pad site. This second new pole and associated guy wire has also been highlighted in the attached sketch.

#### Pole Relocation Near the Temporary Project Offices

One of PG&E's existing poles near the CVGS temporary project offices (located on the north side of Southam Road) is within the planned construction zone of the pipelines exiting the south-west corner of the compressor station site. The pole needs to be moved about 10-feet to the west. As part of this relocation, PG&E will replace the existing transformer on this pole with a new transformer mounted on the same pole. From the new transformer, PG&E will route a

new power line to an existing pole about 15 feet away that CVGS is re-using to provide power to the project offices.

Standard pole construction techniques and equipment will be employed. The work associated with this NTP is scheduled to start during the week of June 1, 2011.

CVGS has provided all the applicable permits, plans, and supporting documentation as part of the Mitigation Monitoring Compliance and Reporting Plan submittals and NTP #1 (which included construction of the remote well pad and compressor station facilities) to the CPUC and additional items to support this NTP request. As you are aware, biological surveys are being conducted daily by the biological monitor in this work area and to-date, no special-status species (including giant garter snake or nesting Swainson's hawks) have been observed. In addition, the poles will be installed within the graded, un-vegetated road shoulders. No sensitive resources occur within this area and therefore none will be disturbed by this activity. The biological monitor will continue to survey and monitor all work in the area.

Please let me know if you have any questions.

Regards,

A handwritten signature in black ink that reads "Jim Kiefer". The signature is written in a cursive, flowing style.

Jim Kiefer  
Director Project Development  
Central Valley Gas Storage

CC:  
David Hochart/Scott Eckardt, Dudek  
Homer Savage, Fluor  
Sue Bushnell Bergfalk, ICF International

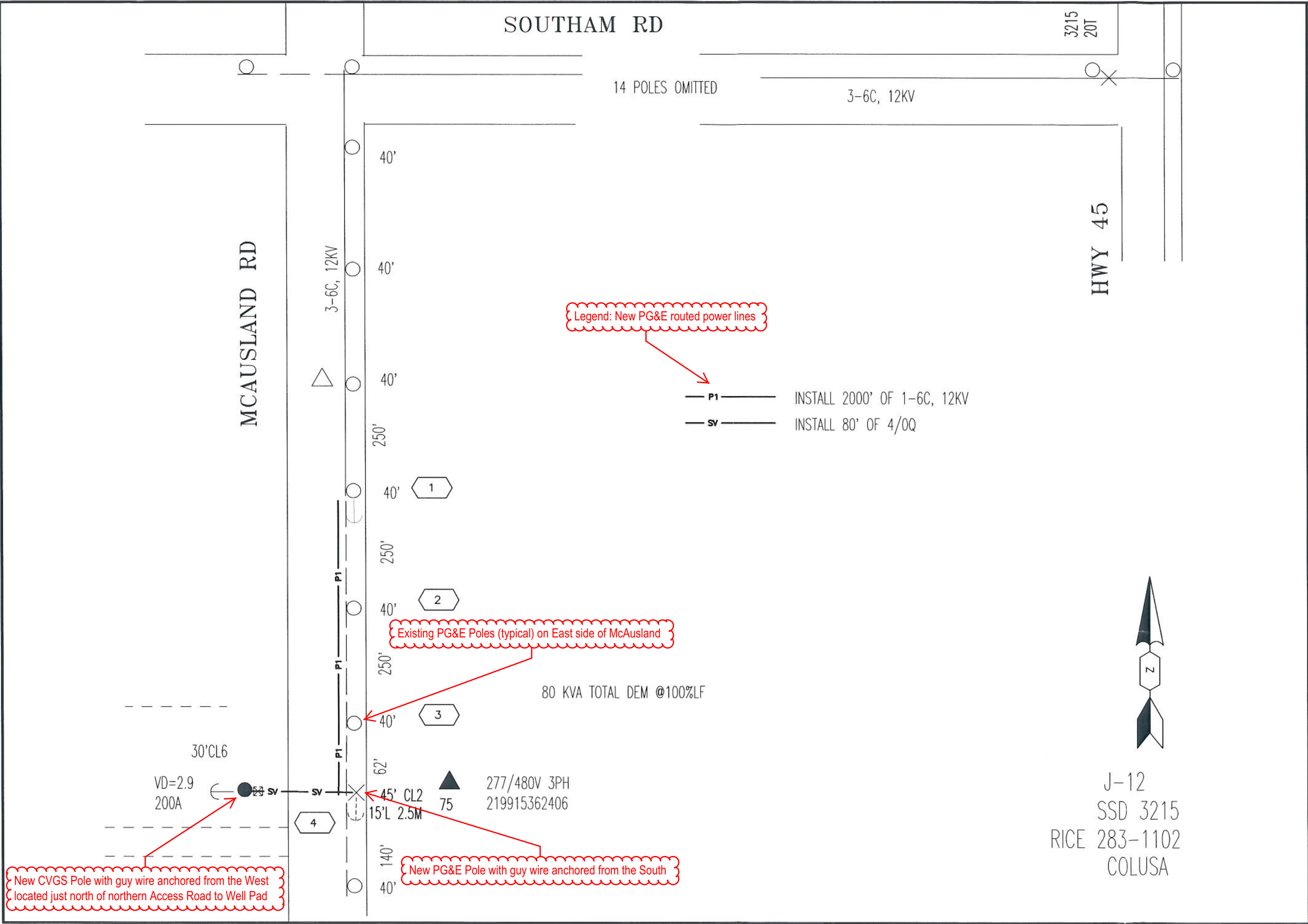

|                     |                    |
|---------------------|--------------------|
| EST: PCP4           | CO:                |
| ADE: PAU1           | SD:                |
| SUPV: MIKE WILLIAMS | NOTIF.:            |
| REP: JOSH DEADMORE  | OTHER:             |
| PLNR:               | SHT: 1 OF 1 SHEETS |
| SCALE: NTS          | DATE: 9-9-2010     |
|                     | REV.:              |
|                     | PM: 30797655       |

**CENTRAL VALLEY GAS STORAGE**  
 McAusland Rd, Colusa  
 12kv ext, 3ph tx

PACIFIC GAS AND ELECTRIC COMPANY

CALL USA BEFORE DIGGING  
UG FACILITIES IN AREA

MCAUSLAND RD

— sv — 15' OF 4/0T

VD=5.0  
15,000 MIN SCI  
400A MAIN

Existing Pole near Construction  
Trailers being re-used by CVGS

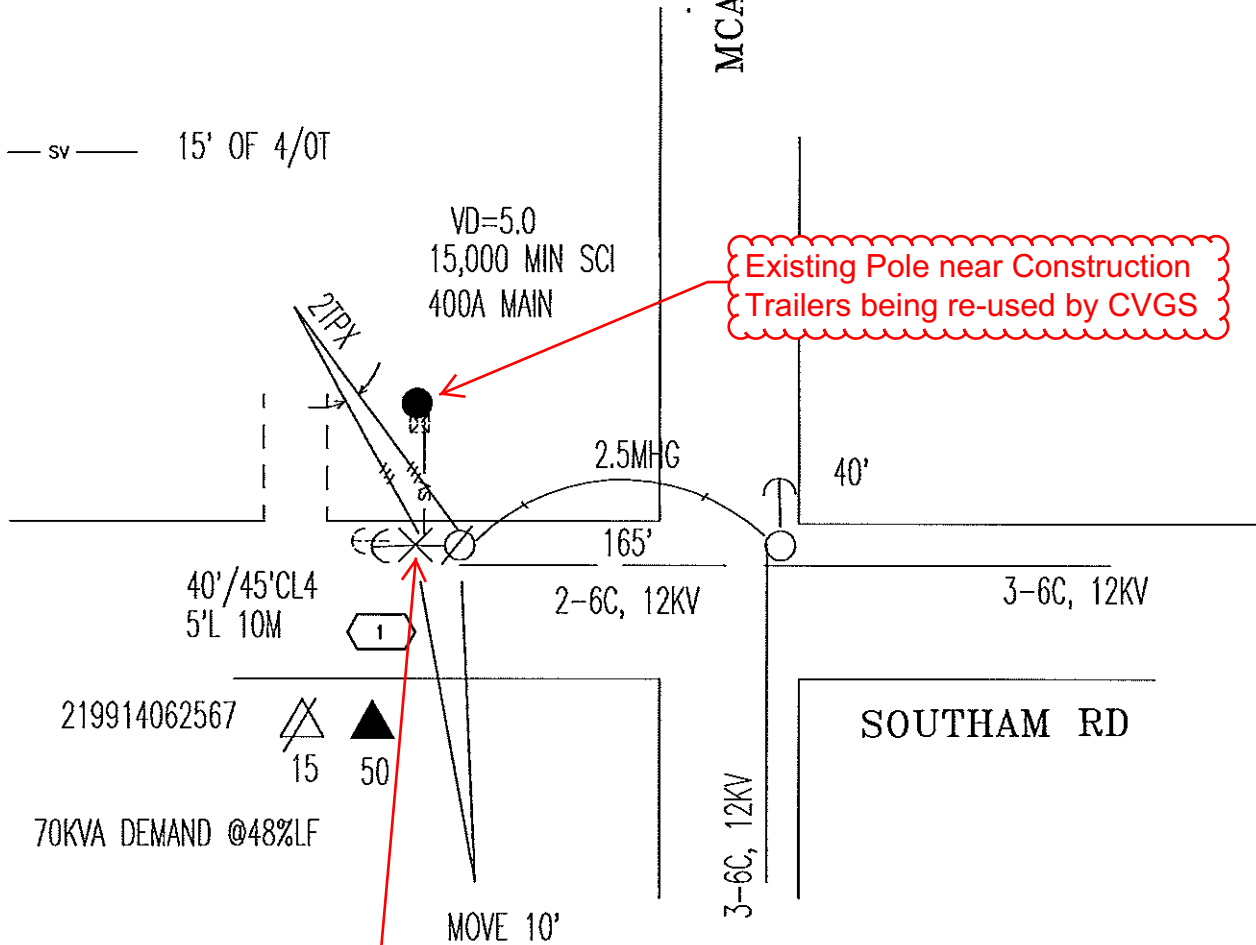

40'/45'CL4  
5'L 10M

2.5MHG

40'

165'

2-6C, 12KV

3-6C, 12KV

219914062567

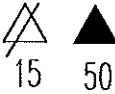

70KVA DEMAND @48%LF

SOUTHAM RD

3-6C, 12KV

MOVE 10'

Existing PG&E Pole being re-located 10-feet and re-used  
by PG&E with guy wire anchored from the West

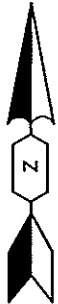

J-12  
SSD-3215

POLE MOVED DUE TO NEW GAS DISTRIBUTION PIPES

RICE 283-1102  
COLUSA/PRINCETON

|        |               |
|--------|---------------|
| EST:   | PCP4          |
| ADE:   | PATTY UNANGST |
| SUPV:  | MIKE WILLIAMS |
| REP:   | JOSH DEADMORE |
| PLNR:  |               |
| SCALE: | NONE          |
| DATE:  | 4/1/11        |



CENTRAL VALLEY GAS STORAGE  
SOUTHAM RD  
PRINCETON/COLUSA

PACIFIC GAS AND ELECTRIC COMPANY

|        |            |
|--------|------------|
| CO:    | OH SERVICE |
| SD:    |            |
| NOTIF: |            |
| OTHER: |            |
| SHT:   | 10F1       |
| PM:    | 30809966   |
| SHEETS | REV.       |